

Zoning Plan Reference

**CITY OF  
LAKE FOREST PARK  
ZONING W/ADDRESSES**  
(ADOPTED 2/24/2000)

Applicant location  
3030 NE 200th Street

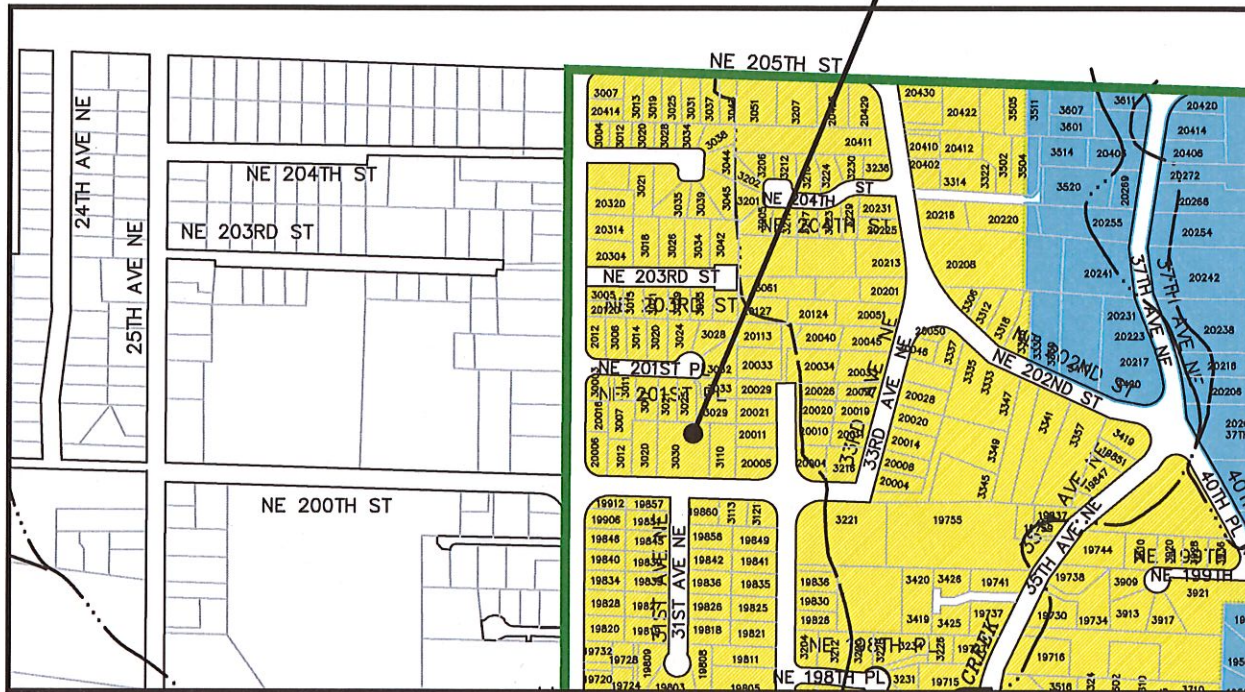



**Chapter 18.22**

**RS-7.2 SINGLE-FAMILY RESIDENTIAL, HIGH**

The following are permitted uses in an RS-7.2 zone:

- A. A single-family dwelling of a permanent character, placed in a permanent location.
- B. Home occupations, provided they meet the criteria in LFPMC 18.50.040.
- C. Accessory buildings and structures in accordance with the provisions in LFPMC 18.50.060.
- D. Manufactured housing bearing the certification of the State of Washington Department of Labor and Industries.
- E. Accessory dwelling units in accordance with the provisions in LFPMC 18.50.050.
- F. Signs in accordance with the provisions in Chapter 18.52 LFPMC.
- G. Type I day care facility in accordance with the provisions in LFPMC 18.50.045

**LEGEND**

	RS 20,000	RS 20,000 SINGLE FAMILY RESIDENTIAL/ MIN. LOT SIZE 20,000 SQ. FT
	RS 15,000	RS 15,000 SINGLE FAMILY RESIDENTIAL/ MIN. LOT SIZE 15,000 SQ. FT
	RS 10,000	RS 10,000 SINGLE FAMILY RESIDENTIAL/ MIN. LOT SIZE 10,000 SQ. FT
	RS 9,600	RS 9,600 SINGLE FAMILY RESIDENTIAL/ MIN. LOT SIZE 9,600 SQ. FT
	RS 7,200	RS 7,200 SINGLE FAMILY RESIDENTIAL/ MIN. LOT SIZE 7,200 SQ. FT
	RM 3,600	RM 3,600 MULTI-FAMILY RESIDENTIAL/ 3,600 SQ. FT PER UNIT
	RM 2,400	RM 2,400 MULTI-FAMILY RESIDENTIAL/ 2,400 SQ. FT PER UNIT
	RM 1,800	RM 1,800 MULTI-FAMILY RESIDENTIAL/ 1,800 SQ. FT PER UNIT
	RM 900	RM 900 MULTI-FAMILY RESIDENTIAL/ 900 SQ. FT PER UNIT
	BN	NEIGHBORHOOD BUSINESSES
	C.C.	CORRIDOR COMMERCIAL
	TC	TOWNE CENTRE